

Miesville Ravine Park Reserve

Spring-Summer-Fall Trail Map

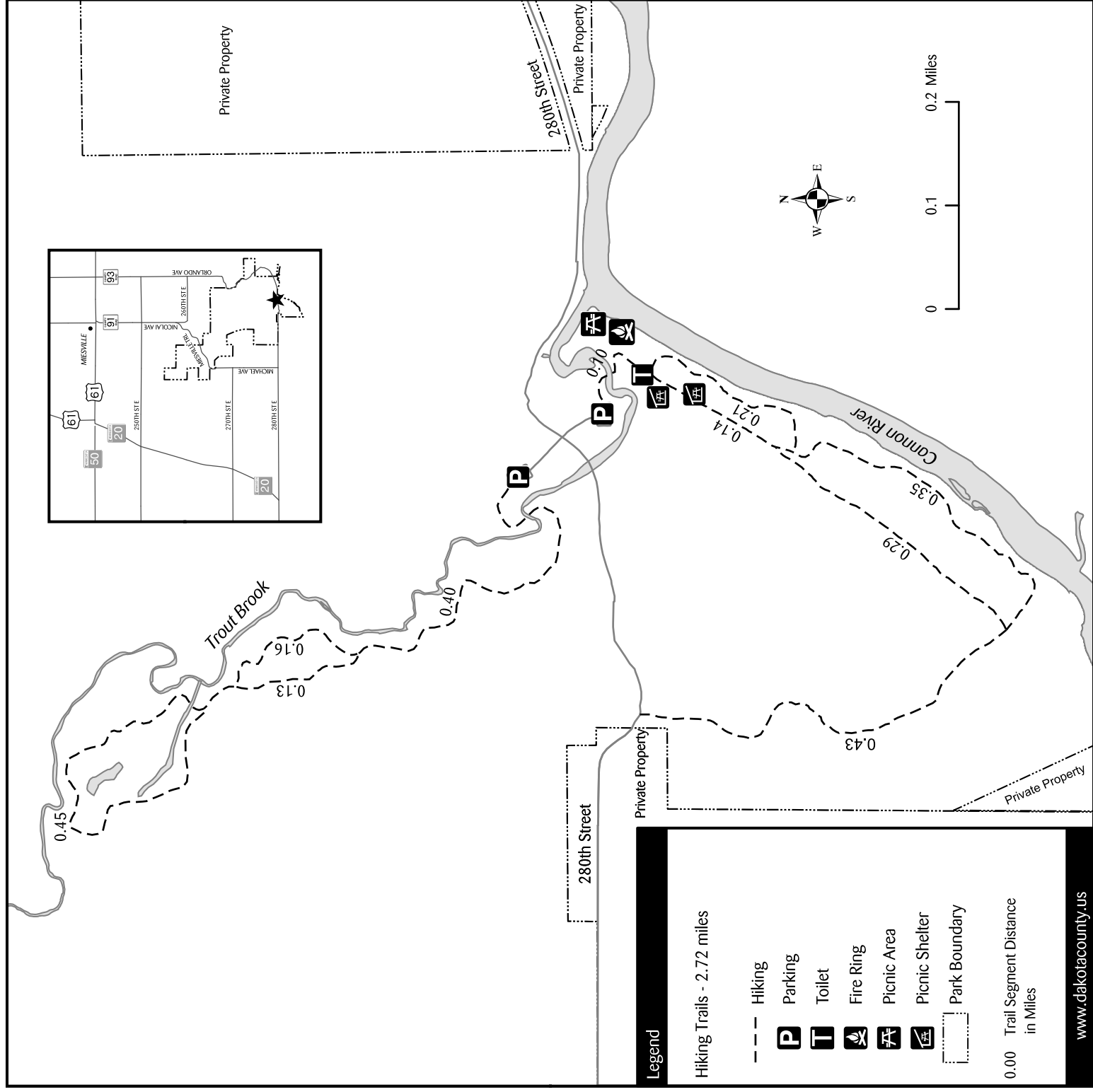

Park hours: 5 a.m. to 10 p.m.



Legend

Hiking Trails - 2.72 miles

- Hiking
- Parking
- Toilet
- Fire Ring
- Picnic Area
- Picnic Shelter
- Park Boundary

0.00 Trail Segment Distance in Miles

www.dakotacounty.us

Miesville Ravine Park Reserve

Welcome to Miesville Ravine Park Reserve. Nestled deep in the heart of the beautiful Cannon River Valley, this 1,600 acre reserve offers scenic trails along Trout Brook and the Cannon River.

Miesville Ravine Park Reserve is part of the Dakota County Park System.

Park features

- Nature trails for hiking
- Trout fishing
- Wildflowers

So everyone can enjoy the park...

- Use trails for their intended purpose.
- Leashed pets are welcome. Please put pet waste in the garbage.

Admission and parking are free.

Miesville Ravine Park Reserve

Miesville, Minnesota 

Spring-Summer-Fall Trail Map

Dakota County Parks

Emergency / Park Ranger: 911

Park Office: 952-891-7000

TDD: 952-891-7968

Lebanon Hills Visitor Center: 651-554-6530

Email: parks@co.dakota.mn.us

www.dakotacounty.us

Please recycle.



2011

Dakota
COUNTY 
forever wild
PARKS