

DAKOTA COUNTY CITIES, VILLAGES & TOWNSHIPS

CITIES	1970 CENSUS	INDEX	VILLAGES	1970 CENSUS	INDEX
HASTINGS	12,179	C-5	SUNFISH LAKE	269	A-3
SOUTH ST. PAUL	25,016	A-3	VERMILLION	359	D-4
WEST ST. PAUL	18,799	A-3			
TOWNSHIPS					
APPLE VALLEY	8,502	C-2	CASTLE ROCK	1,235	E-3
BURNSVILLE	19,940	C-2	DOUGLAS	552	E-5
COATES	212	D-4	EAGAN	10,398	B-2
FARMINGTON	3,104	D-3	EMPIRE	1,136	D-3
HAMPTON	369	E-4	EUREKA	860	E-2
INVER GROVE HEIGHTS	12,148	B-3	GREENVALE	624	F-2
LAKEVILLE	7,556	D-2	HAMPTON	595	E-4
LILYDALE	664	A-3	MARSHAN	1,186	D-5
MENDOTA	327	A-2	NININGER	554	C-4
MENDOTA HEIGHTS	6,165	A-3	RANDOLPH	267	F-4
MIESVILLE	192	E-5	RAVENNA	550	D-6
NEW TRIER	153	E-4	ROSEMOUNT	2,697	C-3
RANDOLPH	350	F-4	SCIOTA	213	F-3
ROSEMOUNT	1,337	C-3	VERMILLION	779	D-4
			WATERFORD	521	F-3



DAKOTA COUNTY
CIVIL DEFENSE DIRECTOR
 ROBERT C. BURTON, JR.
 1442 WOODHILL ROAD
 BURNSVILLE, MINNESOTA 55378
 TELEPHONE 890-1379

HOW TO FIND ADDRESS OF HOUSE

A) HOUSE LOCATED ON NORTH & SOUTH STREETS

EXAMPLE: ADDRESS OF - 30400 ISLE ST.

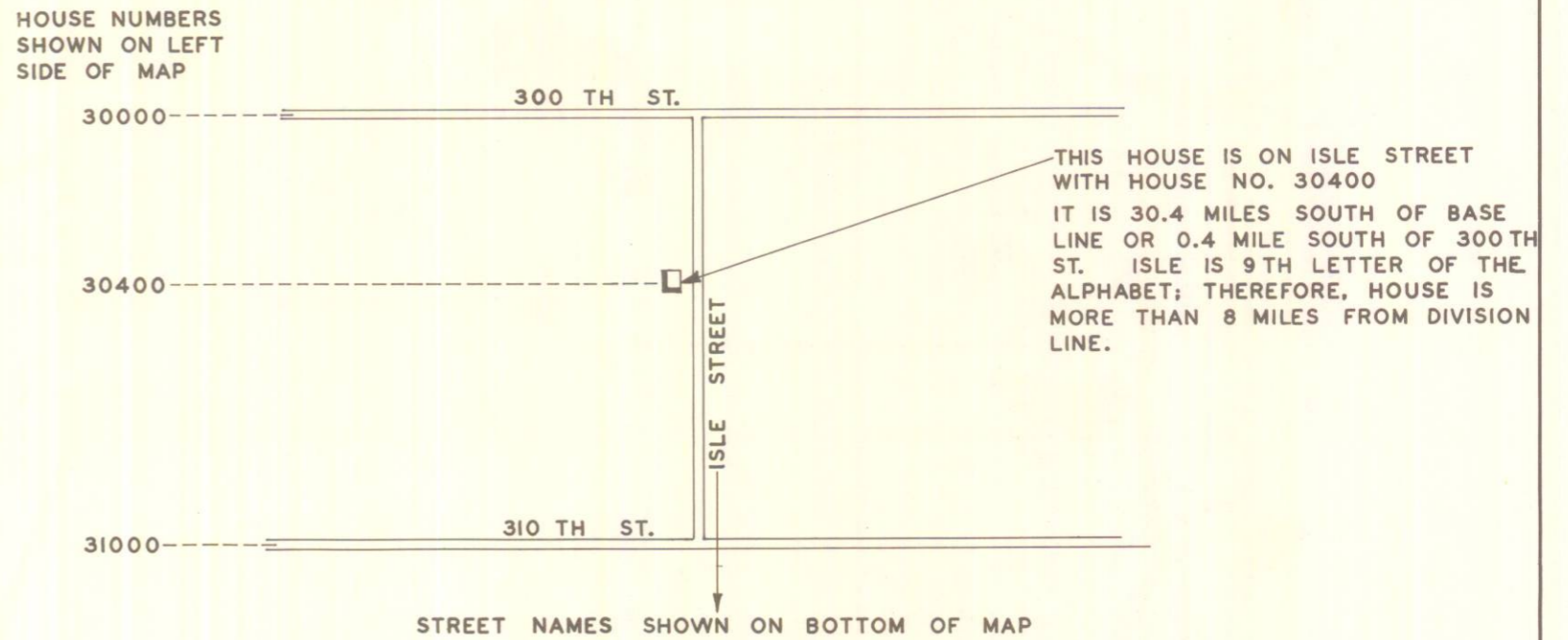

B) HOUSE LOCATED ON EAST & WEST STREETS

EXAMPLE: ADDRESS OF - 13900 - 272 ND ST. E.

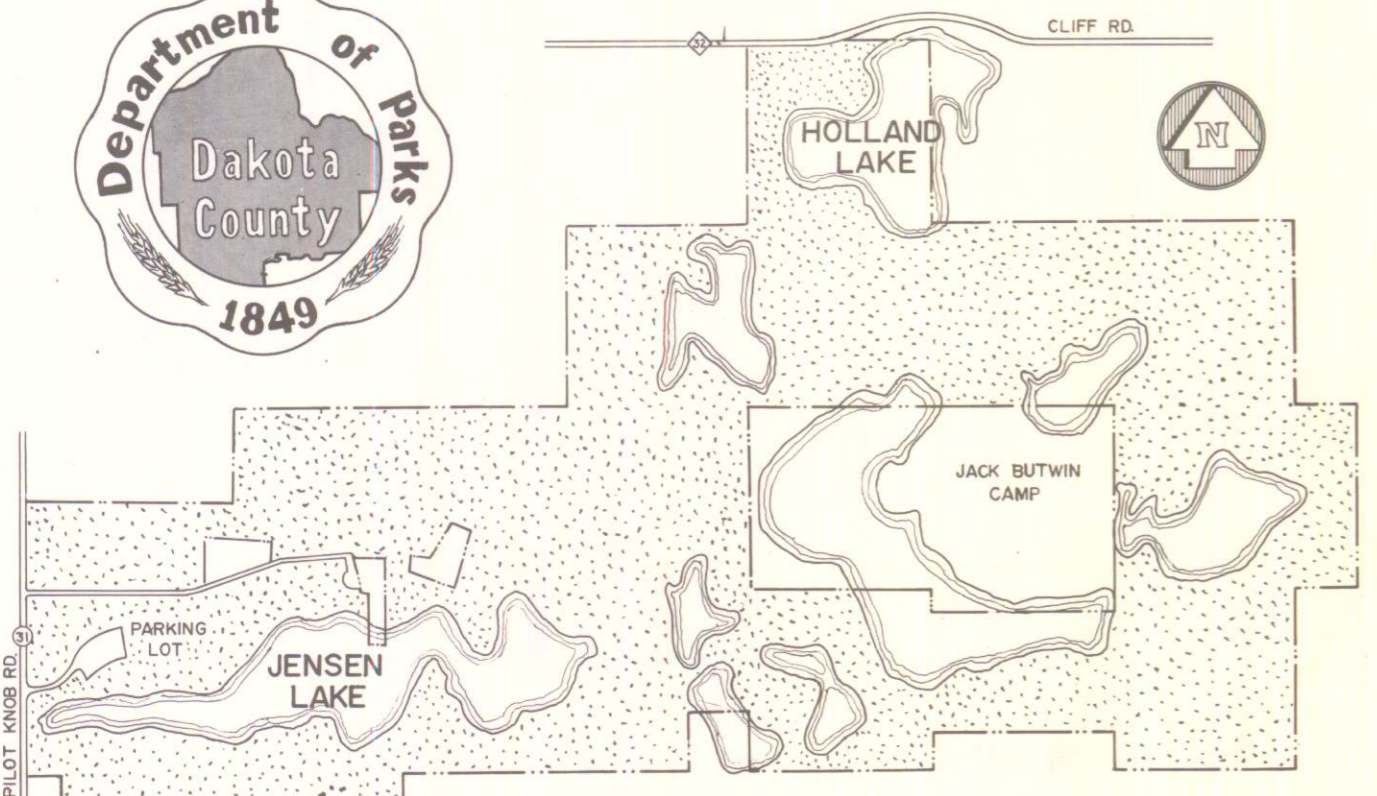
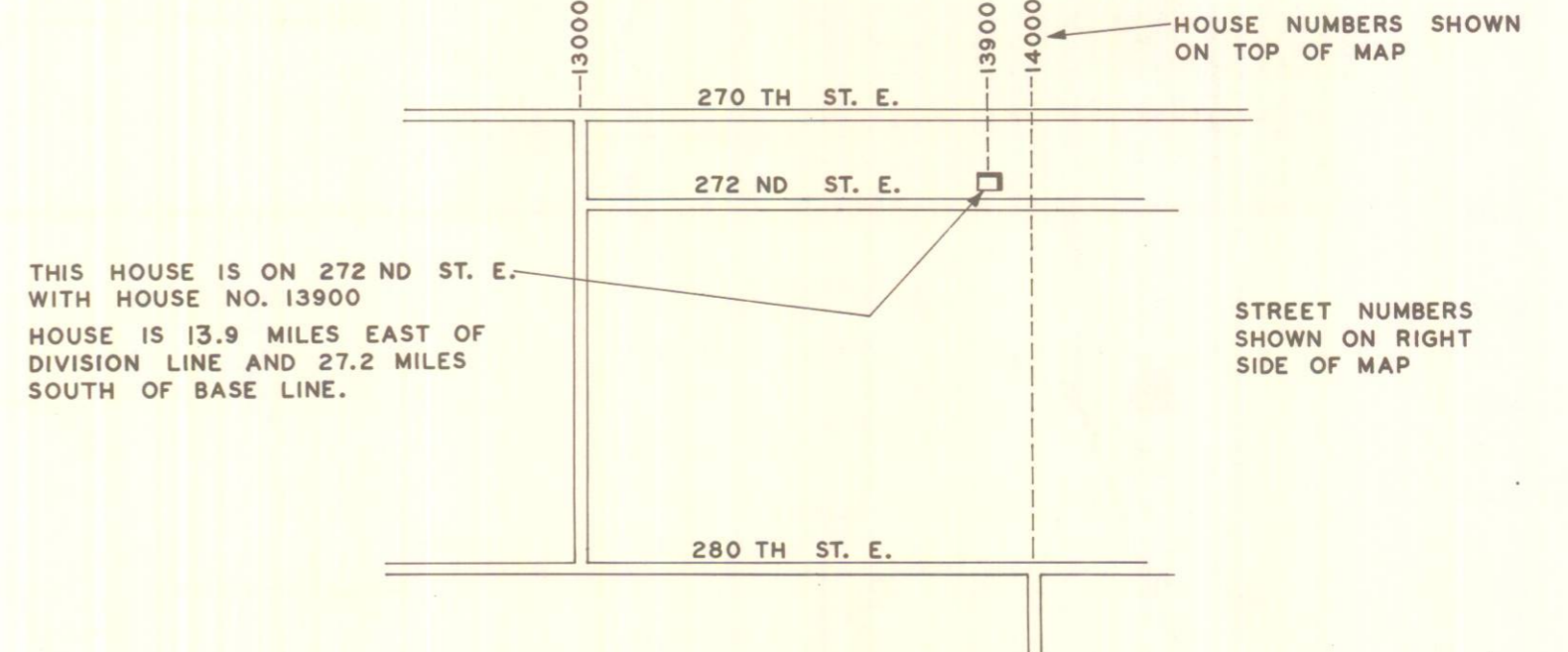

HOLLAND JENSEN LAKE PARK

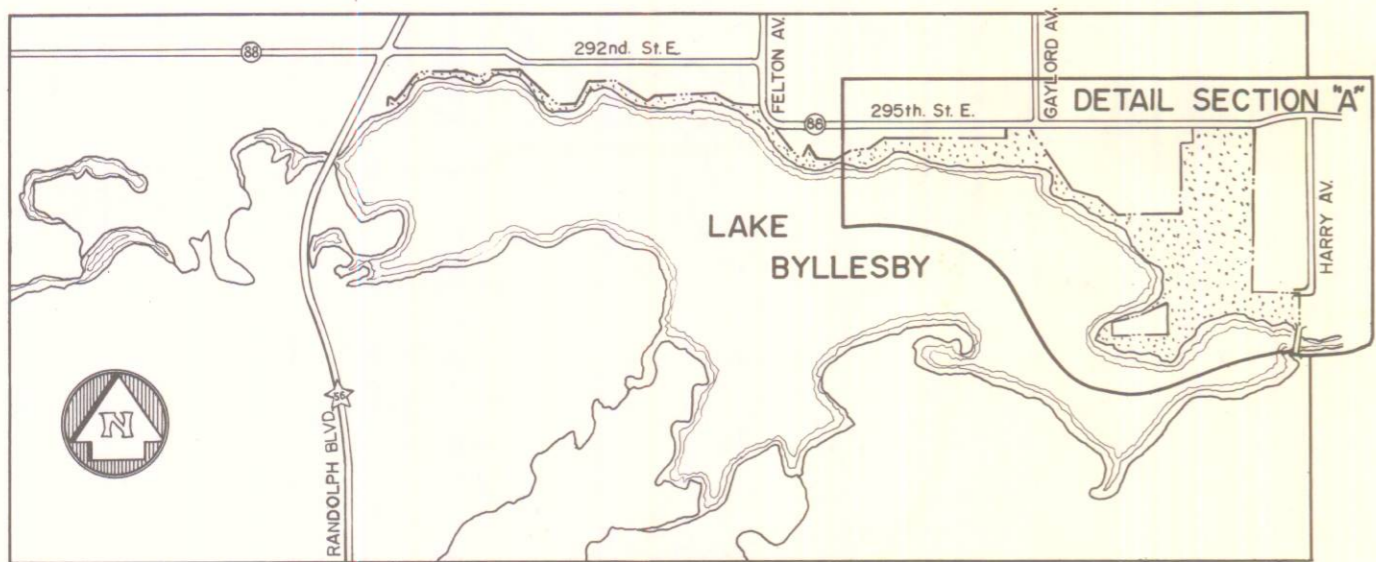

LAKE BYLLESBY PARK

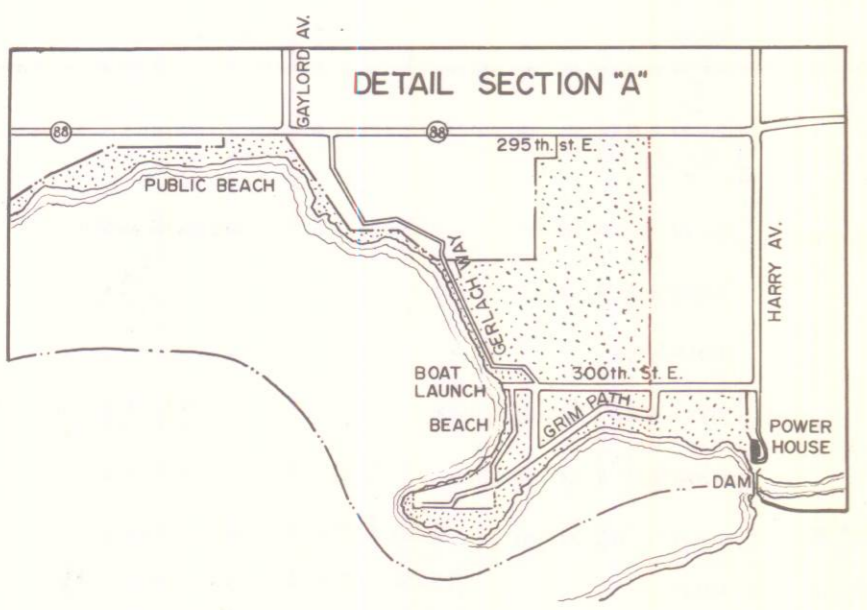

LEGEND

DAKOTA COUNTY
 R/W
 PARK

BOUNDARY MARKER

PUBLIC PRIVATE

SUGGESTED MAIL BOX INSTALLATION

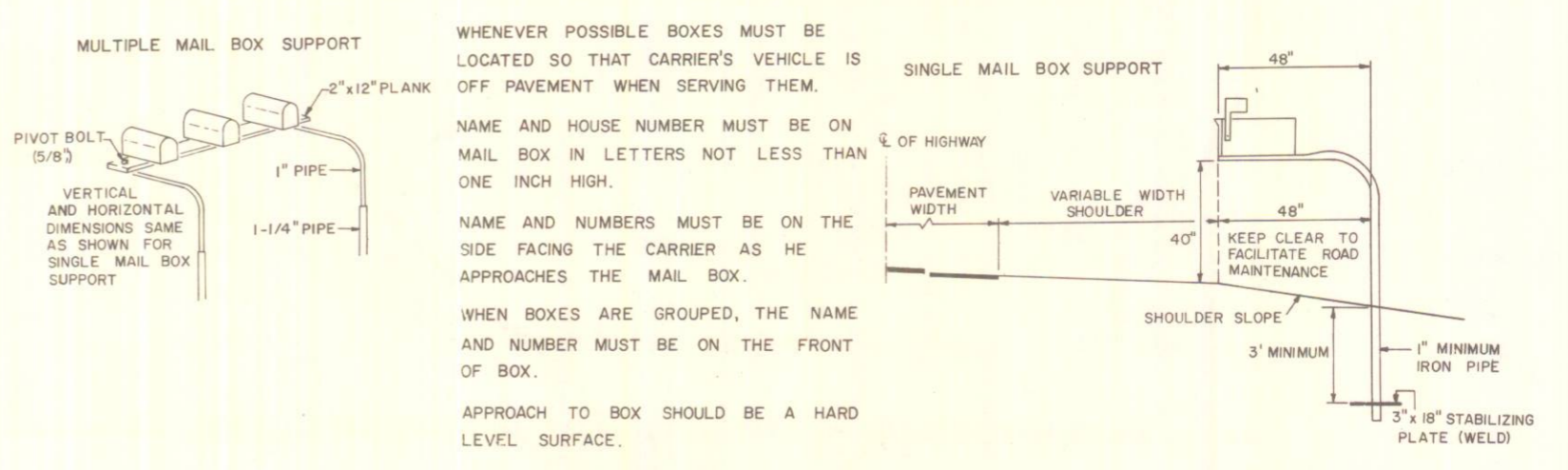

MOST ACCIDENTS ARE CAUSED BY THE DRIVER

- FOUR COMMON ACCIDENT CAUSES ARE:
1. THE DRIVER DIDN'T THINK
 2. HE DIDN'T LOOK
 3. HE DIDN'T KNOW
 4. HE DIDN'T CARE

TO KEEP OUT OF ACCIDENTS AVOID DISTRACTION, HIGH SPEED, TAKING CHANCES, DRIVING AFTER DRINKING AND FATIGUE. WATCH OUT FOR PEDESTRIANS. BE DOUBLY CAREFUL AFTER DARK.

SAFETY BELTS SAVE LIVES

APPROXIMATELY 10,000 LIVES A YEAR WOULD BE SAVED BY USING SAFETY BELTS, ACCORDING TO SAFETY AUTHORITIES.

