









Pedestrian Crossing Safety Enhancements

Lexington Ave
Wilderness Run Road
Dakota County, Minnesota

LEGEND

	BITUMINOUS ROADWAY
	CONCRETE MEDIAN
	CURB AND GUTTER
	CONCRETE WALK
	BITUMINOUS TRAIL
	BOULEVARD
	RECTANGULAR RAPID FLASHING BEACON
	PROPOSED LIGHT

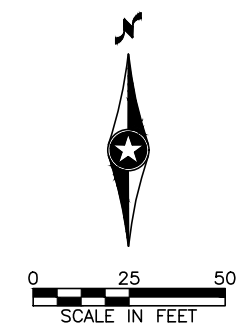
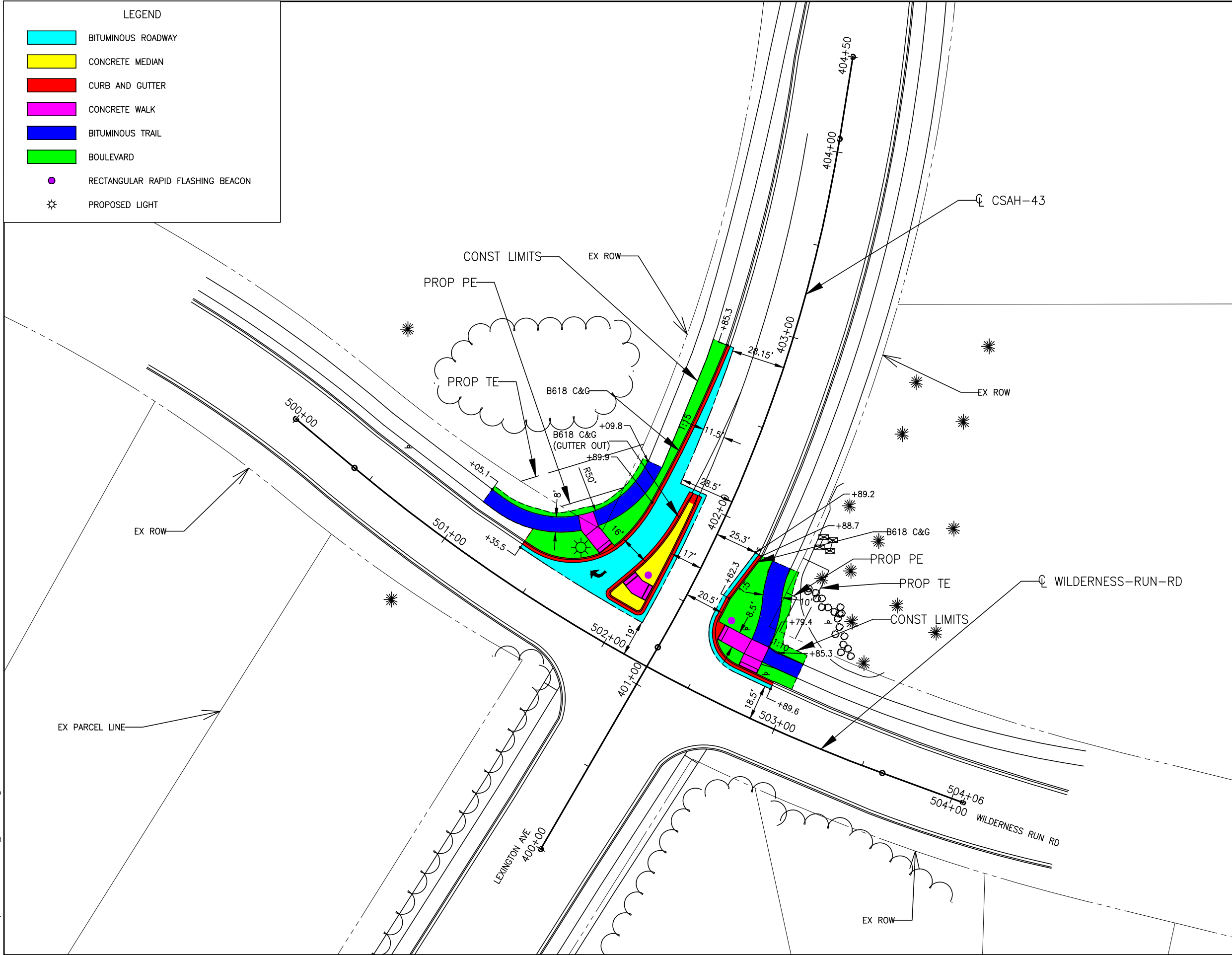

C:\srf-pw\142094\16134_ Exhibits.dwg : Exhibit3

